

Unity Gain $\frac{1}{4}$ λ Mobile Antenna for the 450 MHz Band

DESCRIPTION

- External antenna whip mounted on the GPS-Combi mount.
 - Flexible antenna made of steel wire covered with black silicone tubing.
 - Easily removable for car wash.
- GPS-antenna for fixed installations.
 - Full hemispherical coverage.
 - Built-in high gain, low noise amplifier.
 - Right-Hand Circularly Polarized antenna (RHCP).
 - 5 V supply voltage (3 V respectively 12 V available on request).
 - DC supply via RF-connector.



ORDERING

Type	Product No.	Description	Frequency
GPS-C FLEX/70/GSM/s	132000068	MAX.ROOF THICKNESS 2.5 mm	380 - 420 MHz
GPS-C FLEX/70/GSM/l	132000069	MAX.ROOF THICKNESS 2.5 mm	410 - 450 MHz
GPS-C FLEX/70/GSM/h	132000070	MAX.ROOF THICKNESS 2.5 mm	430 - 470 MHz

SPECIFICATIONS

Electrical		
Model	GPS-C FLEX/70/GSM/...	GPS-COMBI MOUNT
Antenna Type	Mobile antenna	Active patch antenna
Polarisation	Vertical	Circular
Pattern Type	Hemispherical	
Impedance	50 Ω	50 Ω
Maximum Input Power	25 W	
Gain (EIA RS-329-1)	0 dB	
Cross Polar Attenuation	> 10 dB (typ.)	
Selectivity	> 45 dB down @ +/- 45 MHz	

Mechanical	
Connection(s)	FME (male for GPS) + FME (female for mobile antenna)
Materials	Silicone tube over flexible bowden wire Chromed brass
Colour	Black
Height	140 mm / 5.51 in.
Max. Roof Thickness	2.5 mm / 0.10 in.
Weight	0.025 kg / 0.06 lb
Mounting	On the GPS-Combi mount

GPS Antenna	
P1dB (GPS Amplifier)	Approx. +7 dBm
Gain (GPS)	28 dBic in axial direction (typ.)
Noise Figure (GPS Amplifier)	< 1 dB (typ.)
Gain (GPS Amplifier)	> 30 dB (typ.)
VSWR (GPS Amplifier)	< 2.0:1
Operating Temperature Range (GPS)	-35 to 75 °C
Installation Torque (GPS)	4 \pm 0.5 Nm
Frequency (GPS)	1575 MHz
Weight (GPS)	0.114 kg / 0.25 lb
Power Supply (GPS)	5 \pm 0.5 VDC (3 V resp. 12 V on request)
Current Consumption (GPS Amplifier)	0.025 mA
Dimensions (GPS)	Approx. 30 x 89 mm
Colour (GPS)	Black
Materials (GPS)	Cu-nite brass, Stainless steel, Reinforced thermoplastic

ADDITIONAL DATA



TYPICAL RESPONSE CURVES

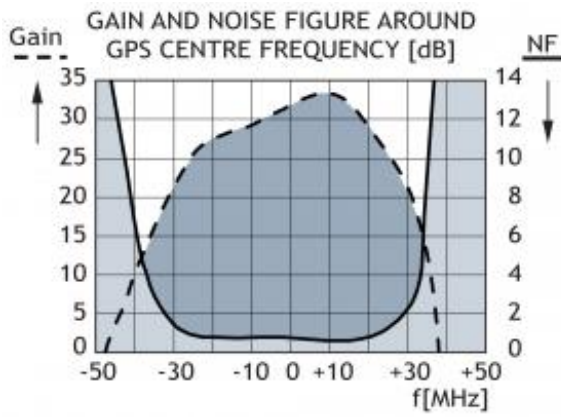
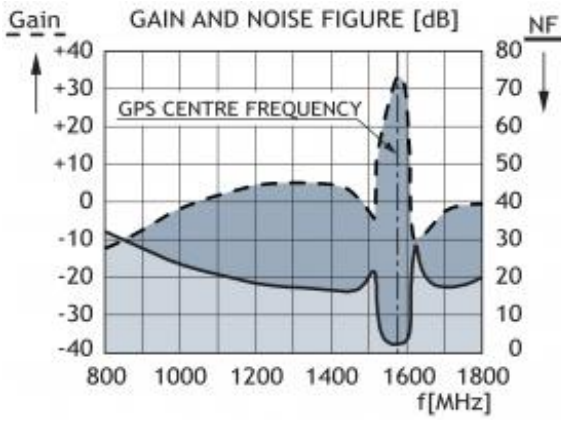

VERTICAL RADIATION PATTERN

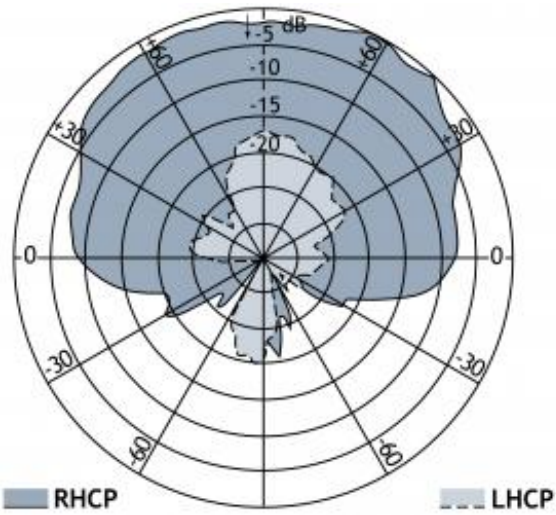

MOUNTING INSTRUCTIONS

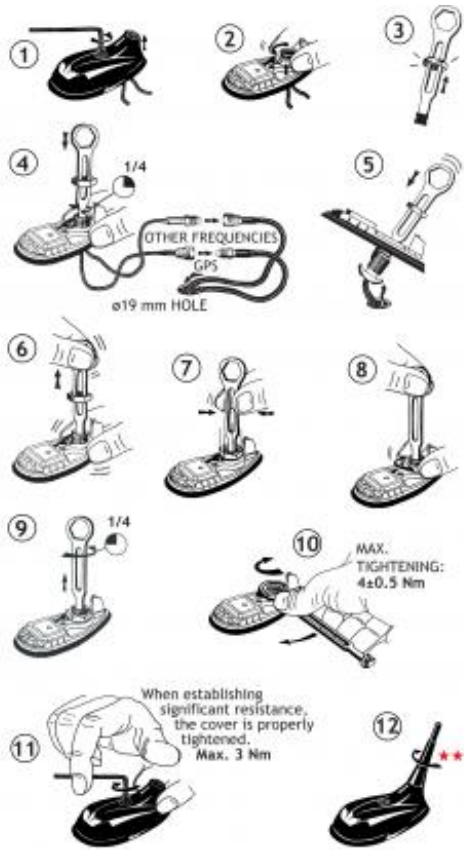

★★ The whip should always be dismantled during car wash.

CABLE MOUNTING

