

## Low Profile Mobile Antenna Mount with Thread Stud

### DESCRIPTION

- Used together with all Amphenol Procom ZG-type antenna whips.
- M8x1 thread whip-mounting system.
- For installation on horizontal surfaces (roof top or trunk lid) in a 21 mm dia. hole.
- Particularly well suited for rooftop-mounting because of very low internal protrusion and ability to be installed exclusively with access from the outside.
- Complete line of whips available for all communications bands up to 1300 MHz.
- Mounting body made of stainless steel!
- Choice between two connection principles:
  - ZG-mount: FME-connection (supplied without cable).
  - ZGP4-mount: Permanently attached 4 m cable terminated with FME-connector.



### ORDERING

Type	Product No.
ZG-Mount	130000377
ZGP4-Mount	130000388
ZGP5-Mount	130000389
1 m FME(f) to FME(f) cable	130000437
2 m FME(f) to FME(f) cable	130000447
3 m FME(f) to FME(f) cable	130000457
4 m FME(f) to FME(f) cable	130000466
5 m FME(f) to FME(f) cable	130000474
6 m FME(f) to FME(f) cable	130000483
4 m FME(f) to FME(f) cable, white	110000064
6 m FME(f) to FME(f) cable, white	110000066
12 m FME(f) to FME(f) cable, white	110000068
18 m FME(f) to FME(f) cable, white	110000069
FME(f)-FME(f) Connector Adaptor	130000583
FME(m)-P(m) (Prolongation) Connector Adaptor	130000565
FME(m)-N(m) Connector Adaptor	130000571
FME(m)-SMA(f) Connector Adaptor	130000578
FME(m)-BNC(m) Connector Adaptor	130000566
FME(m)-TNC(m) Connector Adaptor	130000569
FME(m)-UHF(m) Connector Adaptor	130000572
FME(m)-MiniUHF(m) Connector Adaptor	130000573
FME(m)-MiniUHF(m)(Elbow) Connector Adaptor	130000582
FME(m)-BNC(m)(Elbow) Connector Adaptor	130000580
FME(m)-TNC(m)(Elbow) Connector Adaptor	130000581
FME(m)-SMA(m) Connector Adaptor	130000577

### SPECIFICATIONS

Electrical	
Frequency	0 - 1300 MHz
Application	Low-profile mount for mobile antennas
Mechanical	
Installation Diameter	38 mm / 1.50 in.
Build-In Depth	10.5 mm
Materials	Stainless steel Black chromed brass Environment-proof plastics
Installation Torque	7.5 +/- 1 Nm
Colour	Black
Height	280 mm / 11.02 in.
Whip Connection	M8 x 1 thread stud
Weight	ZG-version: Approx. 70 g ZGP4-version: Approx. 210 g
Mounting	21 mm dia. hole
Mounting Plate Thickness	Max. 2 mm

## ADDITIONAL DATA

## FME-SYSTEM ACCESSORIES

FME-CABLES	
TYPE	PRODUCT NO.
1 m FME(f)	130000437
2 m FME(f)	130000447
3 m FME(f)	130000457
4 m FME(f)	130000466
5 m FME(f)	130000474
6 m FME(f)	130000483
4 m FME-white(f)	110000064
6 m FME-white(f)	110000066
12 m FME-white(f)	110000068
18 m FME-white(f)	110000069

FME-CONNECTORS	
TYPE	PRODUCT NO.
FME(f)-FME(f)	130000583
FME(m)-P(m) (Prolongation)	130000565
FME(m)-N(m)	130000571
FME(m)-FSMA (Female-SMA)	130000578
FME(m)-BNC(m)	130000566
FME(m)-TNC(m)	130000569
FME(m)-UHF(m)	130000572
FME(m)-MUHF(m) (Mini-UHF)	130000573
FME(m)-EMUHF(m) (Elbow-MUHF)	130000582
FME(m)-EBNC(m) (Elbow-BNC)	130000580
FME(m)-ETNC(m) (Elbow-TNC)	130000581
FME(m)-SMA(m)	130000577

For further information about other types of FME-cables and FME-connectors, please compare the cable and connector data sheets under accessories in our catalogue.

## INSTALLATION

The ZG-mount is designed for mounting in a 21 mm dia. hole on horizontal surfaces as e.g. roof top or trunk lid, with access from the outside only.

A good contact surface on the inside of the car body must always be ensured, thus enabling the base plate to get in direct contact with the metal parts of the car, which is of utmost importance for proper performance of the antenna.

The ZG-mount is provided with an M8 x 1 thread mount system. This construction meets the demand for a low profile mobile mount with a slim appearance and with protection against theft of the antenna whip.

When cleaning the car in car-washing machines, the whip is easily removed using a fork spanner. The whip is refitted again by screwing it onto the thread stud and tightening it with the spanner.

## 1. INSTALLATION DIMENSIONS

ZG-MOUNT

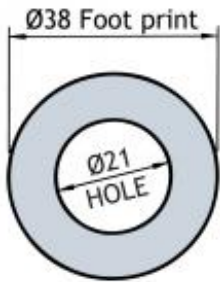

Build- in depth: 10.5 mm

2. INSTALLATION STEPS

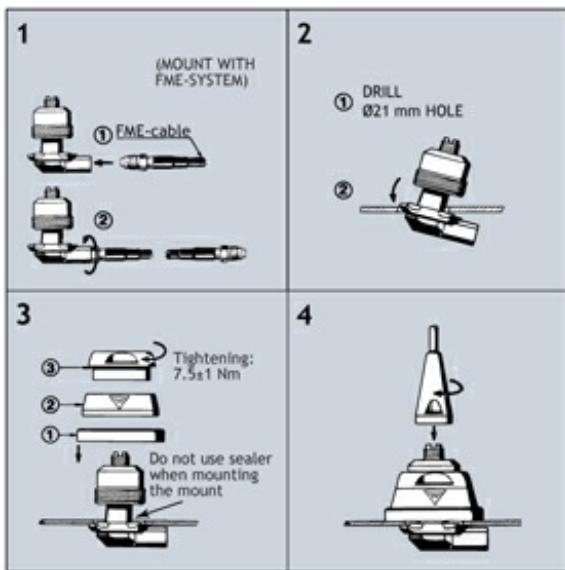

Do not use sealer on rubber gasket or other places.

