

## Unity Gain $\frac{1}{4}$ $\lambda$ Mobile Antenna for the 900 MHz Band

### DESCRIPTION

- > Silicone covered flexible steel wire whip.
- > Type MU 907-ZG/l covers 820 – 905 MHz (e.g. for EAMPS).
- > Type MU 907-ZG/h covers 870 – 960 MHz (e.g. for ETACS, NMT-900 and EGSM).
- > Stainless steel ZG-mount with M8 x 1-thread whip-fastening system.
- > Simple mounting exclusively with access from the outside.
- > Choice between two connection principles:
  - > ZG-mount: FME-connection (supplied without cable).
  - > ZGP4-mount: Permanently attached 4 m low loss cable terminated with FME-connector.

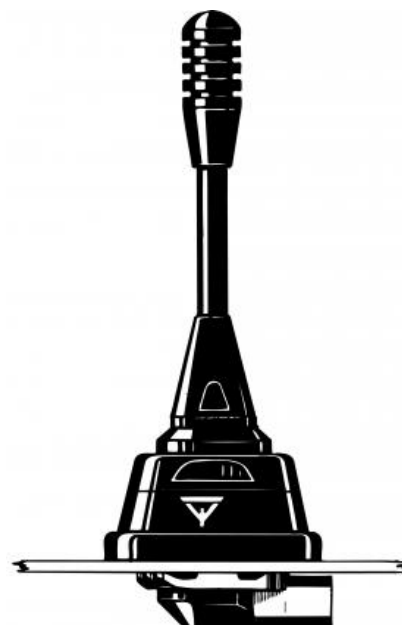

### ORDERING

Type	Product No.	Description	Frequency
MU 907-ZG/l	130001218	ZG-mount with FME	820 - 905 MHz
MU 907-ZG/h	130001216	Same mount as above	870 - 960 MHz
MU 907-ZGP4/l	130001219	ZGP4-mount with 4 m cable and FME-connector	820 - 905 MHz
MU 907-ZGP4/h	130001217	Same mount as above	870 - 960 MHz

### SPECIFICATIONS

Electrical	
Model	MU 907-ZG/...
Frequency	900 MHz-band covered by two models
Antenna Type	Mobile antenna
Polarisation	Vertical
Impedance	50 $\Omega$
Maximum Input Power	60 W
Gain (EIA RS-329-1)	0 dB

Mechanical	
Materials	Whip: Steel wire covered with silicone tubing, Black-chromed brass Mount: Black-chromed brass Weather- and shockproof plastics Stainless steel
Installation Torque	7.5 +/- 1 Nm
Colour	Black
Height	91 mm / 3.58 in.
Weight	ZG-version: Approx. 90 g ZGP4-version: Approx. 230 g
Mounting	21 mm dia. hole

ADDITIONAL DATA

INSTALLATION

This antenna should be mounted on the car roof to ensure best omnidirectional coverage. The antenna is provided with our type ZG-mount for mounting from the outside in a 21 mm dia. hole. The ZG-mount is provided with an M8 x 1 thread mount system. This construction meets the demand for a low-profile mobile mount with a slim appearance and with protection against theft of the antenna whip. When cleaning the car in car-washing machines, the whip is easily removed using a spanner, size 12 mm. The whip is refitted again by screwing it onto the thread stud and tightening it with the spanner.

1. INSTALLATION DIMENSIONS:

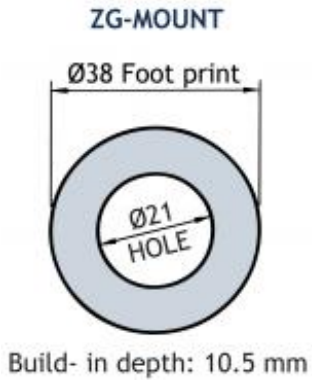

2. INSTALLATION STEPS:

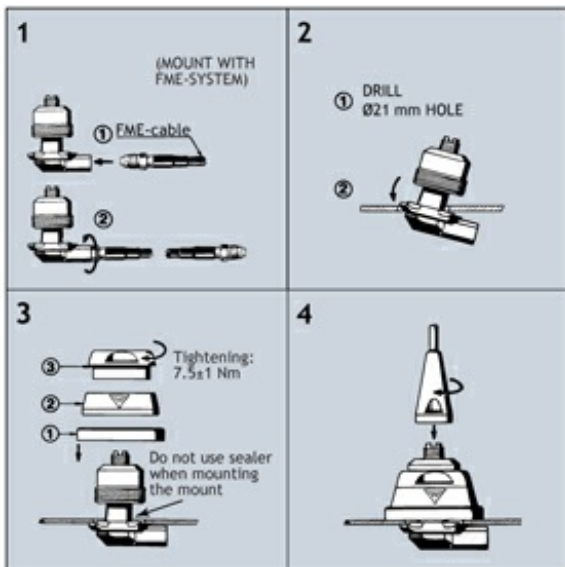

Do not use sealer on rubber gasket or other places.

3. TUNING:

The antenna is delivered factory-tuned and requires no further tuning.