

7/16-3200B-0213

7/16 Plug Clamp

50Ω

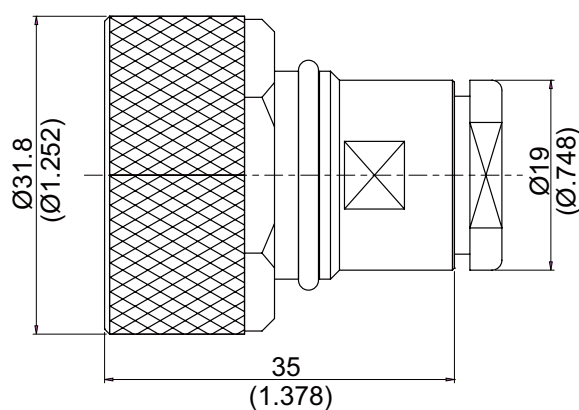

Parts	Material	Plating(Micro-inch)
Nut	Brass	Tin-Zinc-Copper-Alloy 100 Over Copper 50
Washer	Brass	Tin-Zinc-Copper-Alloy 100 Over Copper 50
Braid Clamp	Brass	Tin-Zinc-Copper-Alloy 100 Over Copper 50
Body	Brass	Tin-Zinc-Copper-Alloy 100 Over Copper 50
Gasket	Silicon	
Contact Pin	Brass	Gold 4 Over Nickel-Phosphorus Alloy 80 Over Copper 20
Insulator	Teflon	
Coupling Nut	Brass	Tin-Zinc-Copper-Alloy 100 Over Copper 50

Weight:

Suitable Cables: RG213

This part number complies with RoHS.

Notice: JYEBAO reserves the right to make modifications deemed appropriate.

CABLE ASSEMBLY INSTRUCTION

7/16-3200B-0213

JYE BAO CO., LTD.

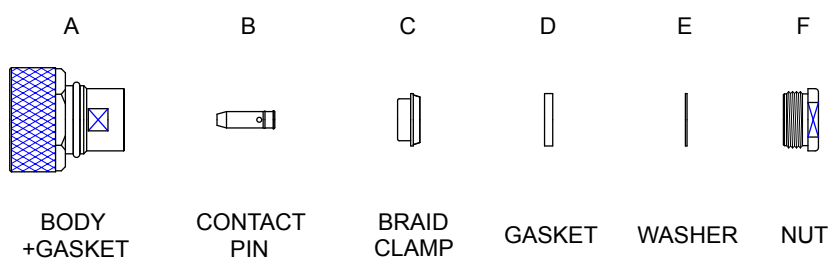
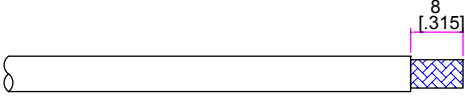
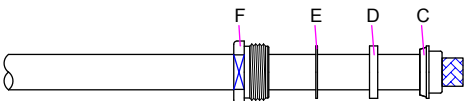
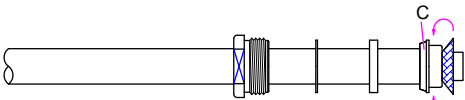
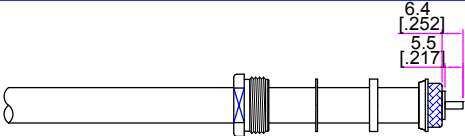
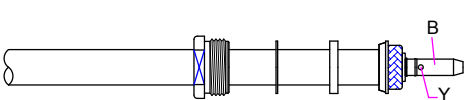
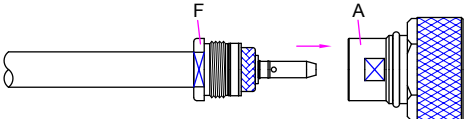

DIAGRAM	ASSEMBLY INSTRUCTION
	Step 1: STRIP AS SHOWN.
	Step 2: SLIDE BRAID CLAMP "C" - GASKET "D" - WASHER "E" AND NUT "F" OVER CABLE.
	Step 3: WRAP THE BRAIDING OVER "C".
	Step 4: STRIP AS SHOWN.
	Step 5: PUT CONTACT PIN "B" ON CENTER CONDUCTOR AND SOLDER IN "Y".
	Step 6: FINALLY SCREW "F" ON THE CONNECTOR BODY "A".

This part number complies with RoHS.

Notice: JYEBAO reserves the right to make modifications deemed appropriate.